

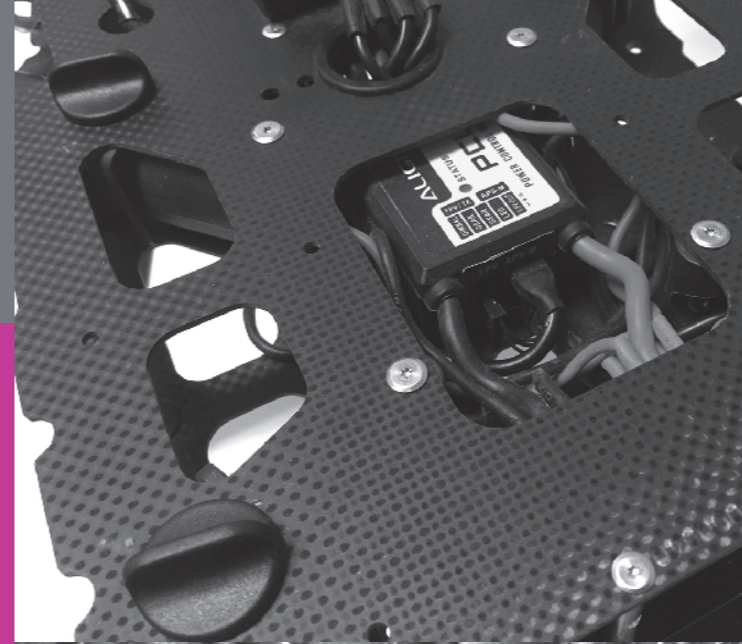

310express Company
A div. of SAIMA CORP.

2-9-17 Tsujido, Fujisawa, Kanagawa
251-0047, Japan

TEL:+81-466-36-3656
FAX:+81-466-36-0009
<http://www.310ex.com>
info@310ex.com



BEST SCREW FOR THIN PLATE FASTENING

Flat head screw is not applicable on thin plate since you will not have enough space for countersinking. 310Slim® achieve nearly flat surface without the head sticking out like truss or pan head screws.

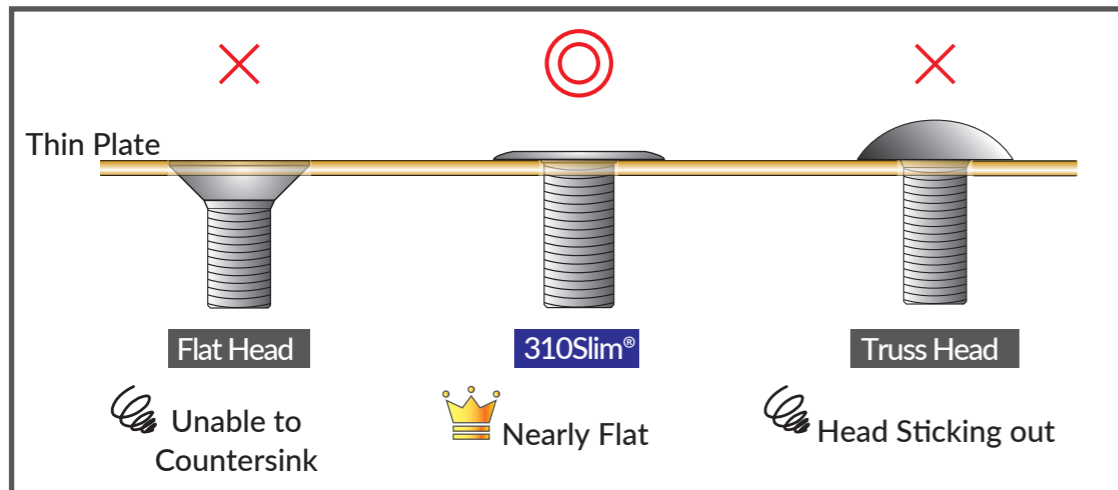

COMPACT DESIGN UNDERHEAD "R" & "UN-THREADED" PART

310Slim® will help to optimize a compact design. Underhead "R" & "Un-threaded" part is designed very small to have bearing surface wide.

- Small "R" = Small clearance hole = Wide bearing surface ⇒ Stable Fastening
- Small "un-threaded" part = Fully threaded under the head ⇒ Best for thin plate fastening

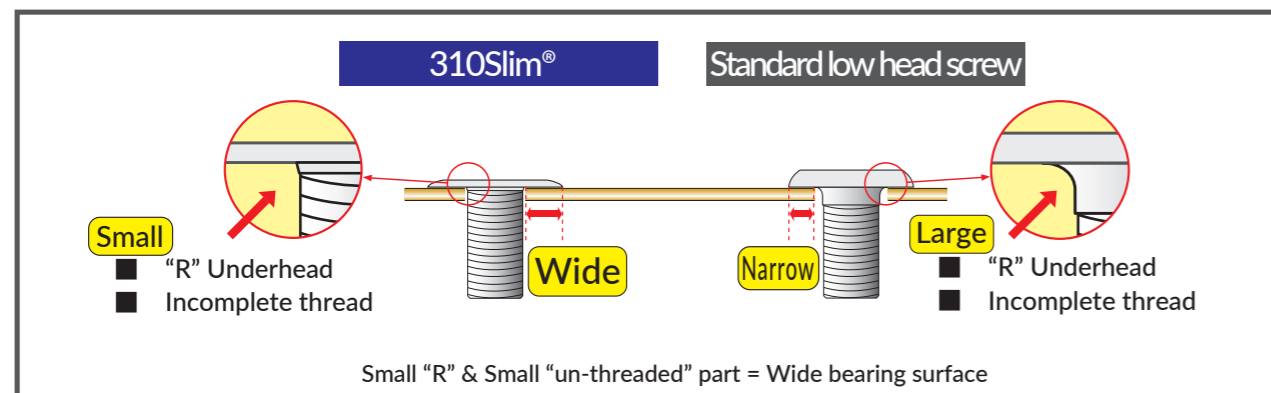

2 RECESS TYPES "6-LOBE" AND "QUA"

■ "6-Lobe" (hexalobular) is a standard recess as it is well known in JIS or ISO (JIS B 1015/ ISO 10664). Therefore, tools are easily can be purchased anywhere at your local DIY stores, hardware supplier, and needless to say, at SAIMA online shop.

■ "Qua" is the advanced cross recess which works perfectly if special "Qua" bit applied. You can also use standard cross recess driver for your convenience.

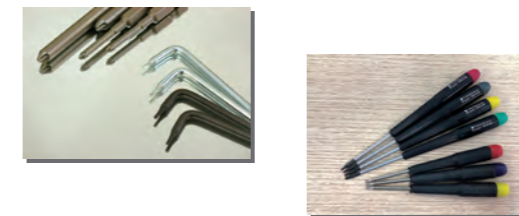

6-Lobe



JIS B1015 / ISO10664
Standard hexalobular recess

Qua



Prevent tools CAM-OUT
by using "QUA" bit.

GOOD TORQUE TRANSMISSION

310Slim® has "6-lobe" or "Qua" recess to make the head part extremely thin. Both recesses have good torque transmission rather than the others such as cross recess or hex socket and the bit fits into the recess perfectly even the recess designed shallow. As a result, you can replace from standard machine screw to 310Slim® today.

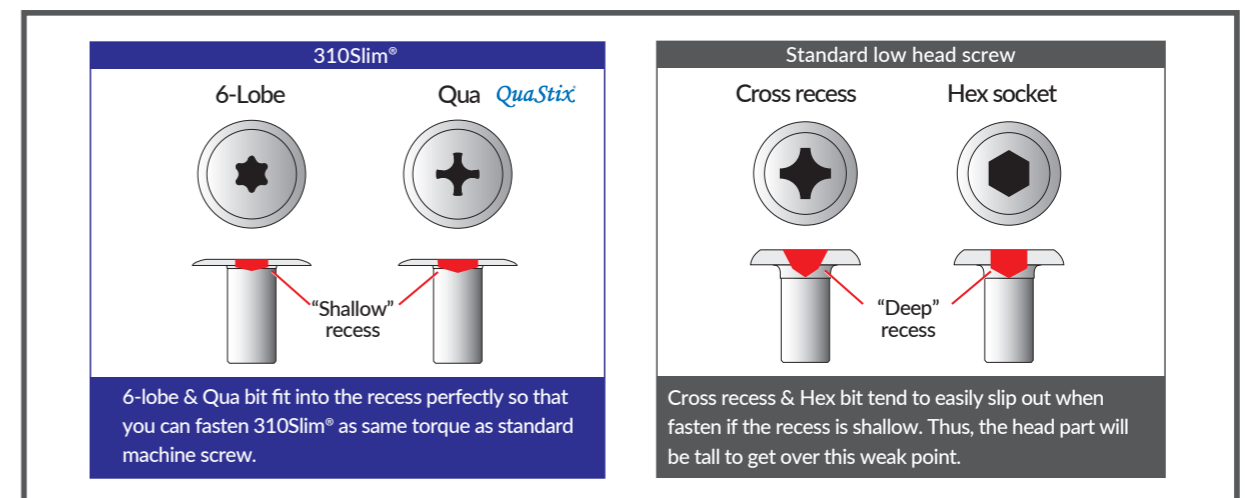

COMPARISON CHART

Head Height

■ M5x20 Stainless A2

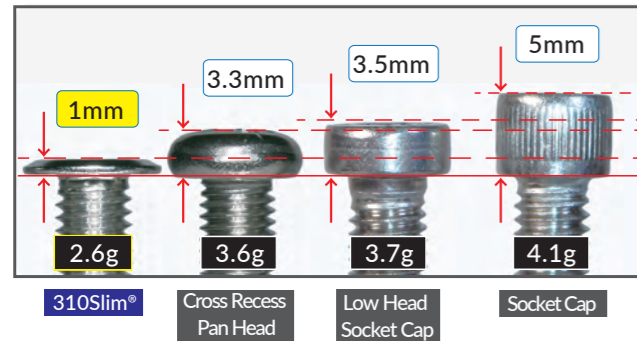

| M5x20 Stainless | 310Slim® | Cross Recess Pan Head Screw | Low Head Socket Cap (DIN7984) | Socket Cap (DIN912) |
|-----------------|----------|-----------------------------|-------------------------------|---------------------|
| Head Height | 1.0mm | 3.3mm | 3.5mm | 5.0mm |
| Weight | 2.6g | 3.6g | 3.7g | 4.1g |



Weight

■ 100pcs. M5x10 screws in various materials.

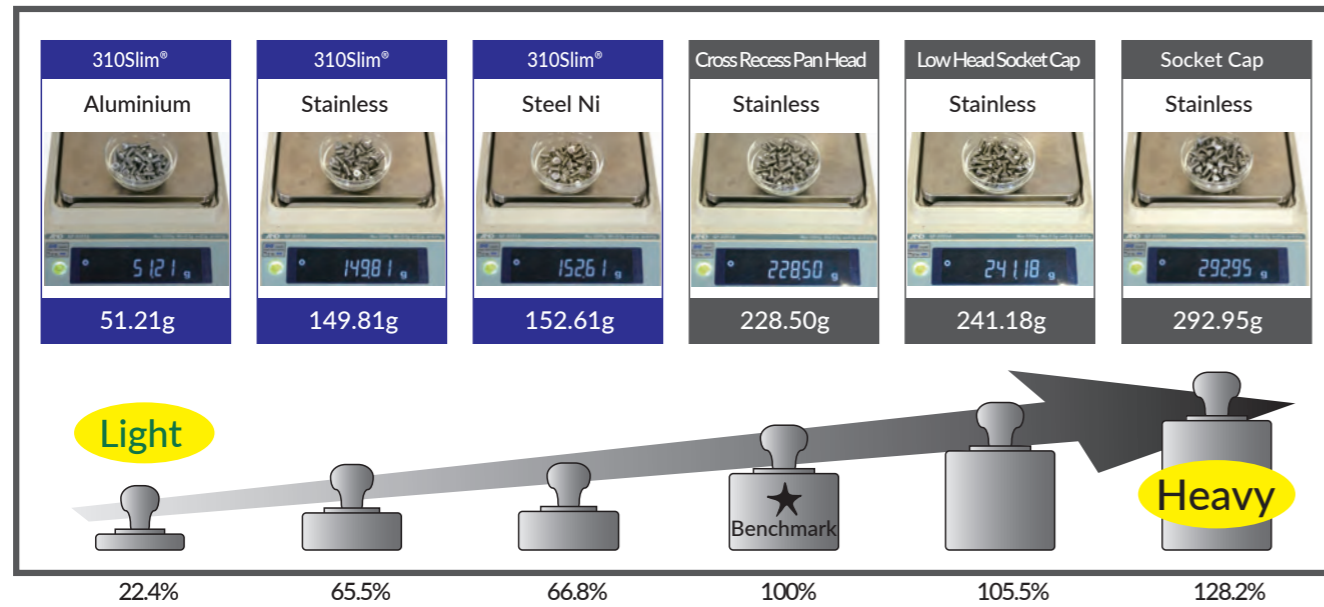

ALL OUR STOCK PLATING GUARANTEE

- Steel 3Cr plating ⇒ 5µm⁺ thickness
- Steel Nickel plating ⇒ Cu + Ni



Steel 3Cr



Steel Nickel
Steel Black Nickel

ALL OUR STOCK HEAD STRENGTH GUARANTEE

310Slim® can be used as same fastening torque as standard 4.8 machine screw that is certified by the below chart. Easy to replace from standard machine screws. Please see the chart below.

■ Standard machine screw fastening torque < 310Slim® Min. breaking torque

Unit : N.m

| Steel & Stainless A2 | M2 | M2.6 | M3 | M4 | M5 | M6 |
|---|------|------|------|------|------|------|
| Machine Screws (Steel 4.8) Standard fastening torque* | 0.17 | 0.35 | 0.63 | 1.48 | 2.98 | 5.07 |
| 310Slim® Minimum breaking torque | 0.40 | 0.50 | 0.95 | 2.30 | 4.00 | 10.0 |

| Aluminium | M2 | M2.6 | M3 | M4 | M5 | M6 |
|---|----|------|------|------|------|------|
| Machine Screws (Al, Brass, Cu) Standard fastening torque* | - | - | 0.31 | 0.74 | 1.49 | 2.55 |
| 310Slim® Minimum breaking torque | - | - | 0.45 | 1.0 | 1.7 | 3.3 |

*Excerpt a reference from TOHNICHI Co. Torque Handbook

310Slim®'s breaking torque is much higher than standard machine screw's fastening torque. 310Slim® won't break as far as it is fastened under standard fastening torque.

■ Breaking torque test (310Slim® M3x6 Steel Black Ni)



310Slim® breaking torque tested by torque analyzer.

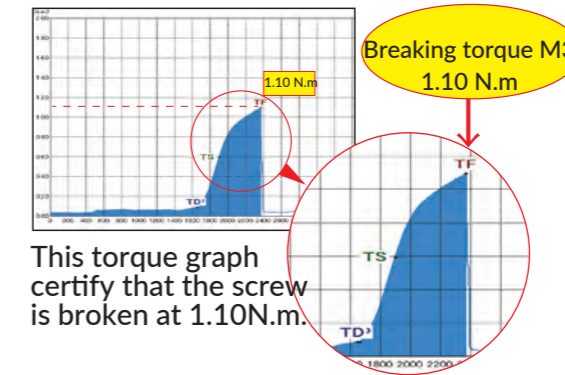

This torque graph certify that the screw is broken at 1.10N.m.

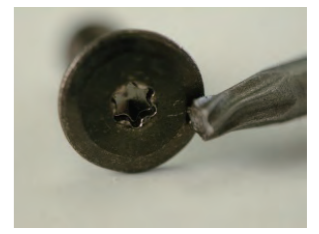

No damage on the recess. The bit is broken instead!

ONLINE STORE

Quick purchase at our web-shop.

Material :
Stainless A2, Steel 3Cr, Steel Black 3Cr,
Steel Nickel, Steel Black Nickel,
Aluminium, Anodized Aluminium

All in stock. Export from 1 pack.

<https://saima-shop.com/>

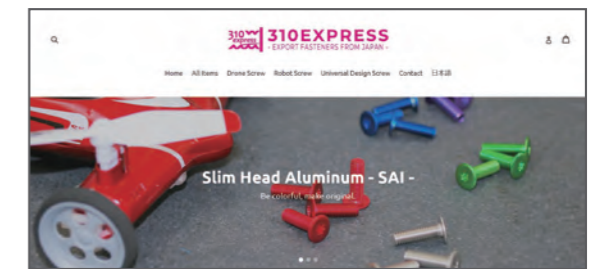



310SLIM® 6-LOBE MACHINE SCREW ALUMINIUM SERIES



LIGHT

- 1/3 weight only comparing Steel or Stainless steel.
- 100pcs standard pack in stock.



INDEX

- 310SLIM® 6-LOBE MACHINE SCREW ALUMINIUM SERIES 7
- 310SLIM® 6-LOBE MACHINE SCREW STAINLESS SERIES 8
- 310SLIM® 6-LOBE MACHINE SCREW STEEL SERIES 9
- 310SLIM® QUA MACHINE SCREW 10
- 310SLIM® NON-SERT THREAD FORMING TAPPING SCREW 10
- TOOL & ASSORTMENT BOX 11

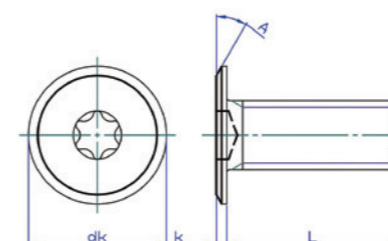

| | M3 | M4 | M5 | M6 |
|---------------------------|-----------------|----------------|----------------|----------------|
| dk | 7 | 8 | 9 | 12 |
| k | 0.8 | 0.9 | 1.0 | 1.2 |
| t (min) | 0.75 | 0.9 | 1.0 | 1.2 |
| Drive | T6 | T8 | T10 | T20 |
| A Approx. | 30° | 30° | 30° | 30° |
| Min Failure Torque | 0.45 N.m | 1.0 N.m | 1.7 N.m | 3.3 N.m |

Aluminium RoHS

| Size | Part# | | Pkg Q'ty |
|------|-------|------------|----------|
| | d | L | |
| M3 | 6 | SH010306AL | 100 |
| | 8 | SH010308AL | 100 |
| | 10 | SH010310AL | 100 |
| M4 | 8 | SH010408AL | 100 |
| | 10 | SH010410AL | 100 |
| | 12 | SH010412AL | 100 |
| | 16 | SH010416AL | 100 |
| M5 | 10 | SH010510AL | 100 |
| | 12 | SH010512AL | 100 |
| | 16 | SH010516AL | 100 |
| | 20 | SH010520AL | 100 |
| M6 | 10 | SH010610AL | 100 |
| | 12 | SH010612AL | 100 |
| | 16 | SH010616AL | 100 |
| | 20 | SH010620AL | 100 |

Anodized Aluminium RoHS

| Size | Part# | | Pkg Q'ty |
|------|-------|---------------|----------|
| | d | L | |
| M3 | 6 | SH010306ALMBK | 100 |
| | 8 | SH010308ALMBK | 100 |
| | 10 | SH010310ALMBK | 100 |
| M4 | 8 | SH010408ALMBK | 100 |
| | 10 | SH010410ALMBK | 100 |
| | 12 | SH010412ALMBK | 100 |
| | 16 | SH010416ALMBK | 100 |
| M5 | 10 | SH010510ALMBK | 100 |
| | 12 | SH010512ALMBK | 100 |
| | 16 | SH010516ALMBK | 100 |
| | 20 | SH010520ALMBK | 100 |
| M6 | 10 | SH010610ALMBK | 100 |
| | 12 | SH010612ALMBK | 100 |
| | 16 | SH010616ALMBK | 100 |
| | 20 | SH010620ALMBK | 100 |

BK = Black, B = Blue, G = Green, P = Purple, R = Red

310SLIM® 6-LOBE MACHINE SCREW STAINLESS SERIES



- Good corrosion resistance, best for thin plate fastening.
- 100pcs standard pack in stock.

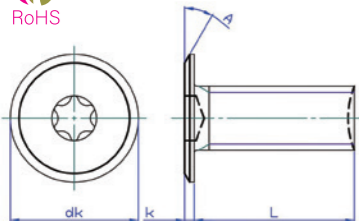

| | M2 | M2.6 | M3 | M4 | M5 | M6 | #6 | #8 | #10 |
|---------------------------|----------------|----------------|-----------------|----------------|----------------|---------------|-----------------|----------------|----------------|
| dk | 4 | 6 | 7 | 8 | 9 | 12 | 7.5 | 8.0 | 8.5 |
| k | 0.5 | 0.6 | 0.8 | 0.9 | 1.0 | 1.2 | 0.85 | 0.9 | 0.95 |
| t (min) | 0.4 | 0.5 | 0.75 | 0.9 | 1.0 | 1.2 | 0.75 | 0.9 | 0.9 |
| Drive | T4 | T5 | T6 | T8 | T10 | T20 | T6 | T8 | T8 |
| A approx. | 30° | 30° | 30° | 30° | 30° | 30° | 30° | 30° | 30° |
| Min Failure Torque | 0.4 N.m | 0.5 N.m | 0.95 N.m | 2.3 N.m | 4.0 N.m | 10 N.m | 0.95 N.m | 2.3 N.m | 2.3 N.m |

*K value is reference Only for Head Painted Product.

Stainless A2 | Blacken(BK) | Bronze(B5) | Light Bronze(B3) |
Neon Peach(NP) | Neon Lemon(NL)

| Size | Part# | | A2 | BK | B5 | B3 | NP | NL | Pkg Q'ty |
|------|-------|------------|----|----|----|----|----|----|----------|
| | d | L | | | | | | | |
| M2 | 4 | SH010204A2 | ○ | ○ | ○ | ○ | - | - | 100 |
| | 5 | SH010205A2 | ○ | ○ | ○ | ○ | - | - | 100 |
| | 6 | SH010206A2 | ○ | ○ | ○ | ○ | - | - | 100 |
| | 8 | SH010208A2 | ○ | ○ | ○ | ○ | - | - | 100 |
| | 10 | SH010210A2 | ○ | ○ | ○ | ○ | - | - | 100 |
| M2.6 | 4 | SH012604A2 | ○ | ○ | ○ | ○ | - | - | 100 |
| | 5 | SH012605A2 | ○ | ○ | ○ | ○ | - | - | 100 |
| | 6 | SH012606A2 | ○ | ○ | ○ | ○ | - | - | 100 |
| | 8 | SH012608A2 | ○ | ○ | ○ | ○ | - | - | 100 |
| M3 | 5 | SH010305A2 | ○ | ○ | ○ | ○ | - | - | 100 |
| | 6 | SH010306A2 | ○ | ○ | ○ | ○ | - | - | 100 |
| | 8 | SH010308A2 | ○ | ○ | ○ | ○ | - | - | 100 |
| | 10 | SH010310A2 | ○ | ○ | ○ | ○ | - | - | 100 |
| M4 | 6 | SH010406A2 | ○ | ○ | ○ | ○ | ○ | ○ | 100 |
| | 8 | SH010408A2 | ○ | ○ | ○ | ○ | ○ | ○ | 100 |
| | 10 | SH010410A2 | ○ | ○ | ○ | ○ | ○ | ○ | 100 |
| | 12 | SH010412A2 | ○ | ○ | ○ | ○ | ○ | ○ | 100 |
| M5 | 8 | SH010508A2 | ○ | ○ | ○ | ○ | ○ | ○ | 100 |
| | 10 | SH010510A2 | ○ | ○ | ○ | ○ | ○ | ○ | 100 |
| | 12 | SH010512A2 | ○ | ○ | ○ | ○ | ○ | ○ | 100 |
| | 16 | SH010516A2 | ○ | ○ | ○ | ○ | ○ | ○ | 100 |
| M6 | 20 | SH010620A2 | ○ | ○ | ○ | ○ | ○ | ○ | 100 |
| | 25 | SH010625A2 | ○ | ○ | ○ | ○ | ○ | ○ | 100 |
| | 30 | SH010630A2 | ○ | ○ | ○ | ○ | ○ | ○ | 100 |
| | 40 | SH010640A2 | ○ | ○ | ○ | ○ | ○ | ○ | 100 |

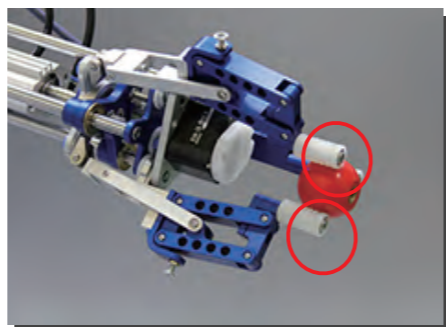
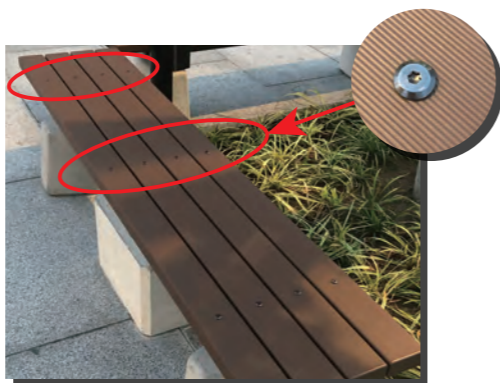

*Head painted product is also available.

310SLIM® 6-LOBE MACHINE SCREW STEEL SERIES



- Beautiful appearance, best choice for stylish furniture.
- 100pcs standard pack in stock.



Steel 3Cr | Surface Hardness HV400min



| Size | Part# | | Pkg Q'ty |
|------|-------|-------------|----------|
| | d | L | |
| M3 | 6 | SH010306Cr3 | 100 |
| | 8 | SH010308Cr3 | 100 |
| | 10 | SH010310Cr3 | 100 |
| M4 | 6 | SH010406Cr3 | 100 |
| | 8 | SH010408Cr3 | 100 |
| | 10 | SH010410Cr3 | 100 |
| M5 | 8 | SH010508Cr3 | 100 |
| | 10 | SH010510Cr3 | 100 |
| | 12 | SH010512Cr3 | 100 |

Inch Steel 3Cr | Surface Hardness HV400min



| Size | Part# | | Pkg Q'ty |
|--------|-------|-------------------|----------|
| | d | L | |
| #6-32 | 1/4 | SH01.00632.020Cr3 | 100 |
| | 3/8 | SH01.00632.030Cr3 | 100 |
| | 1/2 | SH01.00632.040Cr3 | 100 |
| #8-32 | 3/4 | SH01.00632.060Cr3 | 100 |
| | 1/4 | SH01.00832.020Cr3 | 100 |
| | 3/8 | SH01.00832.030Cr3 | 100 |
| #10-24 | 1/2 | SH01.00832.040Cr3 | 100 |
| | 3/4 | SH01.00832.060Cr3 | 100 |
| | 1/2 | SH01.01024.040Cr3 | 100 |
| #10-32 | 5/8 | SH01.01024.050Cr3 | 100 |
| | 3/4 | SH01.01024.060Cr3 | 100 |
| | 1/2 | SH01.01032.040Cr3 | 100 |
| #10-32 | 5/8 | SH01.01032.050Cr3 | 100 |
| | 3/4 | SH01.01032.060Cr3 | 100 |

Steel Nickel | Surface Hardness HV400min



| Size | Part# | | Pkg Q'ty |
|------|-------|------------|----------|
| | d | L | |
| M3 | 6 | SH010306Ni | 100 |
| | 8 | SH010308Ni | 100 |
| | 10 | SH010310Ni | 100 |
| M4 | 6 | SH010406Ni | 100 |
| | 8 | SH010408Ni | 100 |
| | 10 | SH010410Ni | 100 |
| M5 | 8 | SH010508Ni | 100 |
| | 10 | SH010510Ni | 100 |
| | 12 | SH010512Ni | 100 |
| M6 | 16 | SH010516Ni | 100 |

Steel Black Nickel | Surface Hardness HV400min



| Size | Part# | | Pkg Q'ty |
|------|-------|-------------|----------|
| | d | L | |
| M3 | 6 | SH010306BNi | 100 |
| | 8 | SH010308BNi | 100 |
| | 10 | SH010310BNi | 100 |
| M4 | 6 | SH010406BNi | 100 |
| | 8 | SH010408BNi | 100 |
| | 10 | SH010410BNi | 100 |
| M5 | 8 | SH010508BNi | 100 |
| | 10 | SH010510BNi | 100 |
| | 12 | SH010512BNi | 100 |
| M6 | 16 | SH010516BNi | 100 |

310SLIM® QUA MACHINE SCREW & 310SLIM® QUA THREAD FORMING TAPPING SCREW TYPE A



- Advanced cross recess. Standard Cross Recess bit also apply.
- 100pcs standard pack in stock.

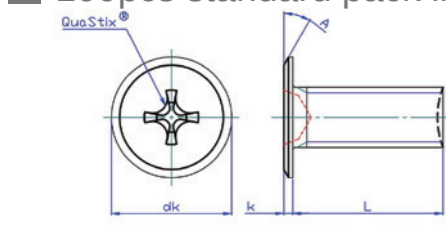

| | M3 | M4 |
|---------------------------|-----------------|----------------|
| dk | 7 | 8 |
| k | 0.8 | 0.9 |
| QS No. | 1 | 2 |
| A approx. | 30° | 30° |
| Min Failure Torque | 0.95 N.m | 2.3 N.m |



QUA Steel 3Cr | Surface Hardness HV400min

| Size | | Part# | Pkg Q'ty |
|------|----|-----------|----------|
| d | L | | |
| M3 | 6 | QSH010306 | 100 |
| | 8 | QSH010308 | 100 |
| | 10 | QSH010310 | 100 |
| | 12 | QSH010312 | 100 |
| M4 | 8 | QSH010408 | 100 |
| | 10 | QSH010410 | 100 |
| | 12 | QSH010412 | 100 |
| | 16 | QSH010416 | 100 |
| M5 | 8 | QSH010508 | 100 |
| | 10 | QSH010510 | 100 |
| | 12 | QSH010512 | 100 |
| | 16 | QSH010516 | 100 |

QUA Steel black 3Cr | Surface Hardness HV400min

| Size | | Part# | Pkg Q'ty |
|------|----|-------------|----------|
| d | L | | |
| M3 | 6 | QSH010306BK | 100 |
| | 8 | QSH010308BK | 100 |
| | 10 | QSH010310BK | 100 |
| | 12 | QSH010312BK | 100 |
| M4 | 8 | QSH010408BK | 100 |
| | 10 | QSH010410BK | 100 |
| | 12 | QSH010412BK | 100 |
| | 16 | QSH010416BK | 100 |
| M5 | 8 | QSH010508BK | 100 |
| | 10 | QSH010510BK | 100 |
| | 12 | QSH010512BK | 100 |
| | 16 | QSH010516BK | 100 |

Qua Stainless A2

| Size | | Part# | Pkg Q'ty |
|------|----|-------------|----------|
| d | L | | |
| M3 | 6 | QSH010306A2 | 100 |
| | 8 | QSH010308A2 | 100 |
| | 10 | QSH010310A2 | 100 |
| | 12 | QSH010312A2 | 100 |
| M4 | 8 | QSH010408A2 | 100 |
| | 10 | QSH010410A2 | 100 |
| | 12 | QSH010412A2 | 100 |
| | 16 | QSH010416A2 | 100 |
| M5 | 8 | QSH010508A2 | 100 |
| | 10 | QSH010510A2 | 100 |
| | 12 | QSH010512A2 | 100 |
| | 16 | QSH010516A2 | 100 |

《TAPPING A》

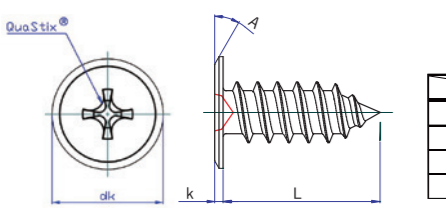

TAPPING SCREW

| | 3 | 4 |
|-----------|-----|-----|
| dk | 7 | 8 |
| k | 0.8 | 0.9 |
| QS No. | 1 | 2 |
| A approx. | 30° | 30° |

QUA Steel 3Cr | Tapping A

| Size | | Part# | Pkg Q'ty |
|------|----|------------|----------|
| d | L | | |
| M3 | 8 | QSH010308A | 100 |
| | 10 | QSH010310A | 100 |
| | 12 | QSH010312A | 100 |
| M4 | 10 | QSH010410A | 100 |
| | 12 | QSH010412A | 100 |
| | 16 | QSH010416A | 100 |
| | 20 | QSH010420A | 100 |

310SLIM® NON-SERT THREAD FORMING TAPPING SCREW



- 6-Lobe recess extremely thin head tapping screw for soft plastic.
- 100pcs standard pack in stock.

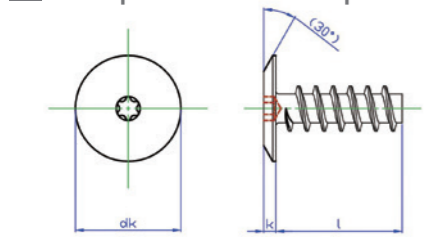

| | 3 | 4 | 5 |
|--------|-----|-----|-----|
| dk | 7 | 8 | 9 |
| k | 0.8 | 0.9 | 1.0 |
| t(min) | 0.5 | 0.5 | 0.6 |
| Drive | T6 | T8 | T10 |



310SLIMNS Steel 3Cr

| Size | | Part# | Pkg Q'ty |
|------|----|------------|----------|
| d | L | | |
| 3 | 6 | NS010306SH | 100 |
| | 8 | NS010308SH | 100 |
| | 10 | NS010310SH | 100 |
| 4 | 8 | NS010408SH | 100 |
| | 10 | NS010410SH | 100 |
| | 12 | NS010412SH | 100 |
| 5 | 10 | NS010510SH | 100 |
| | 12 | NS010512SH | 100 |

310SLIMNS Steel black 3Cr

| Size | | Part# | Pkg Q'ty |
|------|----|--------------|----------|
| d | L | | |
| 3 | 6 | NS010306SHBK | 100 |
| | 8 | NS010308SHBK | 100 |
| | 10 | NS010310SHBK | 100 |
| | 12 | NS010412SHBK | 100 |
| 4 | 8 | NS010408SHBK | 100 |
| | 10 | NS010410SHBK | 100 |
| | 12 | NS010412SHBK | 100 |
| | 16 | NS010416SHBK | 100 |
| 5 | 10 | NS010510SHBK | 100 |
| | 12 | NS010512SHBK | 100 |

TOOL & ASSORTMENT BOX

- 6-Lobe recess(JIS B1015/ISO10664) key and QUA bit for perfect fit on recess.
- 1pc. standard pack in stock.



6-Lobe Key

| PART # | Pkg Q'ty | Remark |
|-----------|----------|--------|
| T4 TRX04L | 1 | M2 |
| T5 TRX05L | 1 | M2.6 |



BIT for 310SLIMQUA

| QS No. | PART # | Length | Pkg Q'ty | Remark |
|--------|--------------|--------|----------|--------|
| 1 | QS01BS | 25.4mm | 1 | M3 |
| 2 | QS02BS | 25.4mm | 1 | M4 |
| 1 | QS01B50-6.35 | 50mm | 1 | M3 |
| 2 | QS02B75-6.35 | 70mm | 1 | M4 |

* WAF6.35



6-Lobe Hand Driver Tool

| PART # | Pkg Q'ty | Remark |
|-----------|----------|---------------------|
| T4 | 6LB04DR | M2 |
| T5 | 6LB05DR | M2.6 |
| T6 | 6LB06DR | M3 |
| T8 | 6LB08DR | M4 |
| T10 | 6LB10DR | M5 |
| T20 | 6LB20DR | M6 |
| 4pcs. Set | 6LBDR-4S | M2 M2.6 M3 M4 |
| 6pcs. Set | 6LBDR-6S | M2 M2.6 M3 M4 M5 M6 |



310Slim® 6-lobe Machine Screw Assortment Box

Part# : 310SHBXA2 (Stainless A2)
15 pcs. each

Sizes : M2x5 | M2x6 | M2x8
M2.6x6 | M2.6x8 | M2.6x10
M3x6 | M3x8 | M3x10 | M3x12
M4x6 | M4x8 | M4x10 | M4x12
M4x16 | M4x20

Part# : 310SHBXST (Steel)
30 pcs. each

Sizes : STEEL 3CR
M3x6 | M3x8 | M4x8 | M4x10

STEEL NI PLATED
M3x8 | M4x8

STEEL BLACK NI PLATED
M3x6 | M3x8 | M4x8 | M4x10